

OS-H-DENS2M-T | 2MP Starlight HDCVI IR Dome Camera



- Starlight, 120dB true WDR, 3DNR
- Max 30fps@1080P
- HD and SD output switchable
- 2.7-13.5mm motorized lens
- Max. IR length 30m, Smart IR
- IP67, POC/DC12V



System Overview

Experience 1080P full HD video and the simplicity of reusing existing coaxial infrastructure with HDCVI. The Starlight HDCVI camera with 120dB true WDR presents a high quality image with rich details even in extreme low-light conditions. It offers various motorized/fixed lens models with a multi-language OSD and HD/SD switchable output. Its superior image performance and starlight feature makes the camera an ideal choice for mid to large-size businesses and projects where both highly reliable surveillance and construction flexibility are needed.

Functions

4 Signals over 1 Coaxial Cable

HDCVI technology supports 4 signals to be transmitted over 1 coaxial cable simultaneously, i.e. video, audio*, data and power. Dual-way data transmission allows the HDCVI camera to interact with the HCVR, such as sending control signal or triggering alarm. Moreover, HDCVI technology supports PoC for construction flexibility.

* Audio input is available for some models of HDCVI cameras.

Long Distance Transmission

HDCVI technology guarantees long-distance and real-time transmission without any loss. It supports up to 800m for 1080P Full HD video via coaxial cable, and up to 300m via UTP cable.*

*Actual results verified by real-scene testing in Osiris's test laboratory

Simplicity

HDCVI technology inherits the born feature of simplicity from traditional analog surveillance system, making itself a best choice for investment protection. HDCVI system can seamlessly upgrade the traditional analog system without replacing existing coaxial cabling. The plug and play approach enables full HD video surveillance without the hassle of configuring a network.

Starlight

With the adoption of high performance sensor, the camera is able to provide incomparable performance even under extreme lowlight environment. The starlight feature allows more details to be captured and accurate color to be recognized at night or in scenes with limited illumination.

Wide Dynamic Range

Embedded with industry leading wide dynamic range (WDR) technology, vivid pictures are achieved even in the most intense contrast lighting conditions. True WDR (120dB) optimizes both the bright and dark areas of a scene at the same time to provide usable video.

Advanced 3DNR

3DNR is noise reduction technology that detects and eliminates random noises by comparing two sequential frames. Osiris's advanced 3DNR technology allows remarkable noise reduction with little impact to sharpness, especially under limited lighting condition. Besides, the advanced 3DNR effectively decreases the band width and saves the storage space.

Multi-formats

The camera supports multiple video formats including HDCVI, CVBS and other two common HD analog formats in the market. The four formats can be switched over through OSD menu or by PFM820 (UTC controller). This feature makes the camera to be compatible with not only HCVRs but also most end users' existing HD/SD DVRs.

Protection

The camera's outstanding reliability is unsurpassed due to its rugged design. The camera is protected against water and dust with IP67, making it suitable for indoor or outdoor environments. The camera complies with an IK10 vandal resistance rating making it capable of withstanding the equivalent of 5 kg (11.02 lbs) of force dropped from a height of 40 cm (15.75 in). Supporting $\pm 30\%$ input voltage tolerance, this camera suits even the most unstable power supply conditions. Its 4KV lightning rating provides protection against the camera and its structure from the effects of lightning.

OS-H-DENS2M-T | 2MP Starlight HDCVI IR Dome Camera

Technical Specifications

Camera						White Balance	Auto / Manual
Image Sensor		1/2.8" CMOS				Smart IR	Auto / Manual
Effective Pixels		1920(H)×1080(V), 2MP				Certifications	
Scanning System		Progressive				Certifications	CE (EN55032, EN55024, EN50130-4) FCC (CFR 47 FCC Part 15 subpartB, ANSI C63.4-2014) UL (UL60950-1+CAN/CSA C22.2 No.60950-1)
Electronic Shutter Speed		PAL: 1/4s~1/100000s NTSC: 1/3s~1/100000s				Interface	
Minimum Illumination		0.004Lux/F1.6, 30IRE, 0Lux IR on				Audio Interface	1
S/N Ratio		More than 65dB				Electrical	
IR Distance		Up to 30m (98feet)				Power Supply	AC 24V±30%/DC 12V±30%
IR On/Off Control		Auto / Manual				Consumption	Max 5.9W (12V DC, IR on)
IR LEDs		2				Environmental	
Lens						Operating Conditions	-30℃ ~ +60℃ (-22°F ~ +140°F) / Less than 95% RH * Start up should be done at above -30℃ (-22°F)
Lens Type		Motorized lens / Fixed iris				Storage Conditions	-30℃ ~ +60℃ (-22°F ~ +140°F) / Less than 95% RH
Mount Type		Board-in				Ingress Protection & Vandal Resistance	IP67 & IK10
Focal Length		2.7-13.5mm				Construction	
Max. Aperture		F1.3				Casing	Aluminium
Angle of View		H: 108.7°~28.7°				Dimensions	Φ122mm×88.9mm (Φ4.8"×3.5")
Focus Control		Auto / Manual				Net Weight	0.43kg (0.95lb)
Close Focus Distance		200mm 7.87"				Gross Weight	0.53kg (1.17lb)
DORI Distance	Lens	Detect	Observe	Recognize	Identify		
	W	44m (144ft)	18m (59ft)	9m (31ft)	5m (15ft)		
	T	153m (502 ft)	61m (201ft)	31m (100ft)	15m (50ft)		
PTZ							
Pan/Tilt Range		Pan: 0° ~ 355° Tilt: 0° ~ 75° Rotation: 0° ~ 355°					
Video							
Resolution		1080P (1920×1080)					
Frame Rate		25/30fps@1080P, 25/30fps@720P					
Video Output		1-channel BNC high definition video output / CVBS video output (Can switch)					
Day/Night		Auto (ICR) / Manual					
BLC Mode		BLC / HLC / WDR					
OSD Menu		Multi-language					
Gain Control		AGC					
Noise Reduction		2D / 3D					
WDR		120dB					

OS-H-DENS2M-T | 2MP Starlight HDCVI IR Dome Camera

Dimensions (mm/inch)

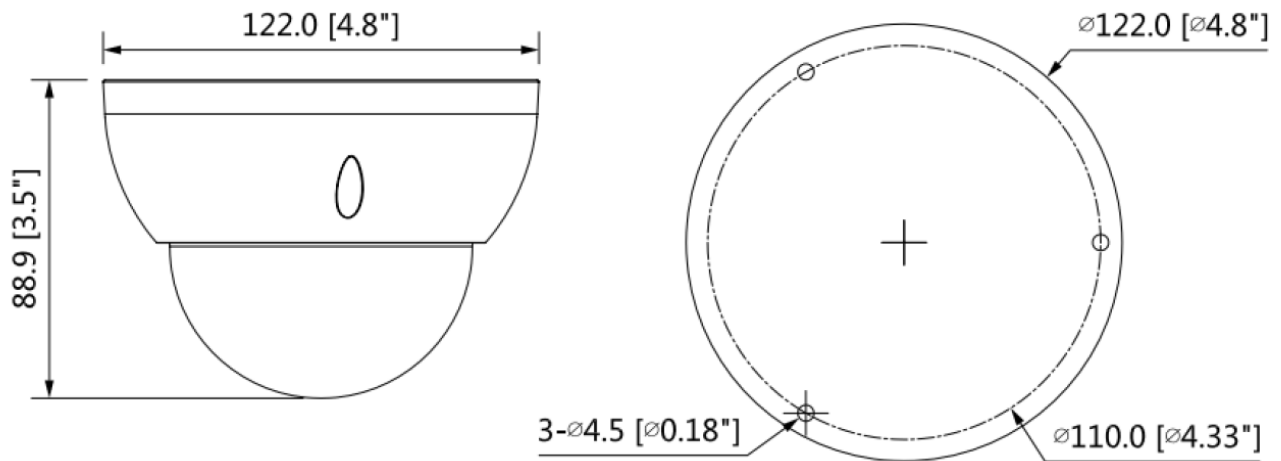

* The information contained in this document (photos, drawings, dimensions, specifications) may be subject to change without prior notice.

** Copyright© Osiris Security. All rights reserved. The information in this document can not be published, rewritten or republished in any form. If you wish to use the text or images in this document for commercial reasons, please contact marketing@osiris-security.com